

ZUPČASTE LETVE

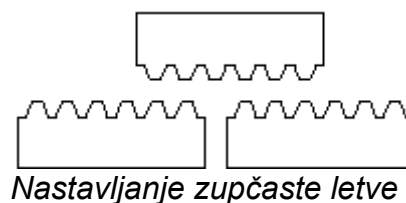

Modul	hp (mm)	he x S (mmxmm)	Lr max (mm)
1	14	15 x 15	2000
1.5	15.5	17 x 17	2000
2	18	20 x 20	2000
2.5	22.5	25 x 25	2000
3	27	30 x 30	2000
4	36	40 x 40	2000
5	45	50 x 50	2000
6	54	60 x 60	2000

Materijal C40 UNI 7845.



Nastavljanje zupčaste letve

Zupčaste letve se prodaju isključivo na dužine od 1000 mm i 2000 mm.

ZUPČANICI

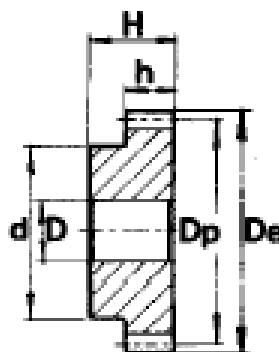

Modul	Z	h (mm)	H (mm)	De (mm)	Dp (mm)	d (mm)	D (mm)
1	15	15	25	17	15	12	6
1	20	15	25	22	20	16	8
1	25	15	25	27	25	20	10
1	30	15	25	32	30	20	10
1	35	15	25	37	35	25	10
1	40	15	25	42	40	25	10
1	45	15	25	47	45	30	10
1	50	15	25	52	50	30	10
1	55	15	25	57	55	40	12
1	60	15	25	62	60	40	12

Modul	Z	h (mm)	H (mm)	De (mm)	Dp (mm)	d (mm)	D (mm)
1.5	15	17	30	25.5	22.5	18	8
1.5	20	17	30	33	30	25	8
1.5	25	17	30	40.5	37.5	25	10
1.5	30	17	30	48	45	30	12
1.5	35	17	30	55.5	52.5	35	12
1.5	40	17	30	63	60	40	12
1.5	45	17	30	70.5	67.5	50	12
1.5	50	17	30	78	75	50	14
1.5	55	17	30	85.5	82.5	60	14
1.5	60	17	30	93	90	60	16
Modul	Z	h (mm)	H (mm)	De (mm)	Dp (mm)	d (mm)	D (mm)
2	15	20	35	34	30	24	10
2	20	20	35	44	40	30	10
2	25	20	35	54	50	35	12
2	30	20	35	64	60	40	14
2	35	20	35	74	70	45	14
2	40	20	35	84	80	50	14
2	45	20	35	94	90	60	16
2	50	20	35	104	100	70	16
2	55	20	35	114	110	70	16
2	60	20	35	124	120	70	16
Modul	Z	h (mm)	H (mm)	De (mm)	Dp (mm)	d (mm)	D (mm)
2.5	15	25	40	42.5	37.5	30	10
2.5	18	25	40	50	45	35	12
2.5	20	25	40	55	50	40	12
2.5	25	25	40	67.5	62.5	50	14
2.5	30	25	40	80	75	55	14
2.5	35	25	40	92.5	87.5	60	16
2.5	40	25	40	105	100	70	16
2.5	45	25	40	117.5	112.5	70	16
2.5	50	25	40	130	125	80	20
2.5	55	25	40	142.5	137.5	90	20
2.5	60	25	40	155	150	100	20
Modul	Z	h (mm)	H (mm)	De (mm)	Dp (mm)	d (mm)	D (mm)
3	15	30	50	51	45	35	12
3	20	30	50	66	60	45	14
3	25	30	50	81	75	60	16
3	30	30	50	96	90	60	16
3	35	30	50	111	105	70	16
3	40	30	50	126	120	80	20
3	45	30	50	141	135	90	20
Modul	Z	h (mm)	H (mm)	De (mm)	Dp (mm)	d (mm)	D (mm)
4	15	40	60	68	60	45	14
4	20	40	60	88	80	60	16
4	25	40	60	108	100	75	20
4	30	40	60	128	120	75	20
4	35	40	60	148	140	80	20
Modul	Z	h (mm)	H (mm)	De (mm)	Dp (mm)	d (mm)	D (mm)
5	15	50	75	85	75	60	20
5	20	50	75	110	100	80	20
5	25	50	75	135	125	90	20
5	30	50	75	165	150	110	25

Modul	Z	h (mm)	H (mm)	De (mm)	Dp (mm)	d (mm)	D (mm)
6	12	60	80	84	72	54	20
6	15	60	80	102	90	70	20
6	20	60	80	132	120	90	20
6	25	60	80	162	150	110	25

Materijal C43 UNI 7847.